



Pin Header 2.54mm 1 & 2 & 3 Row H=1.5/1.7/2.5mm Straight Type

Specifications

Current Rate: 3 AMP
 Insulation Resistance: 1000MΩ Min.
 Contact Resistance: 20mΩ Max.
 Dielectric Voltage: 1000V AC for one minute
 Operation Temperature: -40°C to +105°C

Material

Insulator: P.B.T or Hi-Temp. Thermoplastic, UL 94V-0
 Terminal: Copper Alloy
 Standard Plating: Gold Flash

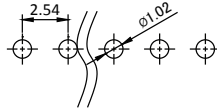
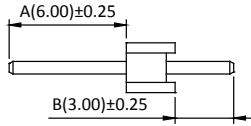
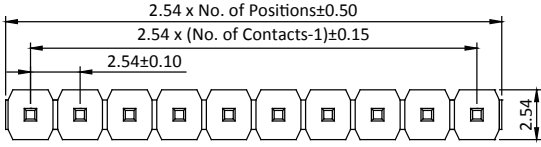

P/N.: 5PH1SDA15/17/25-1XX

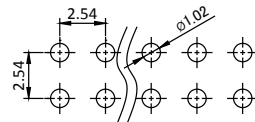
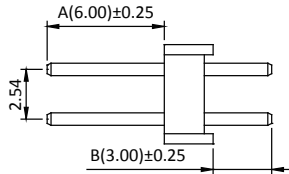
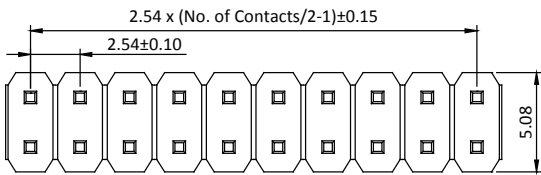
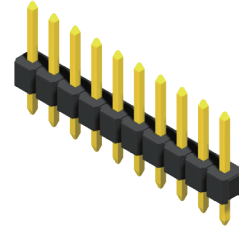

P/N.: 5PH1SDA15/17/25-2XX

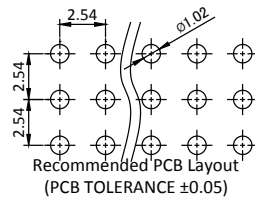
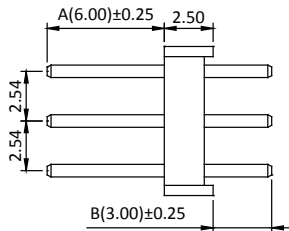
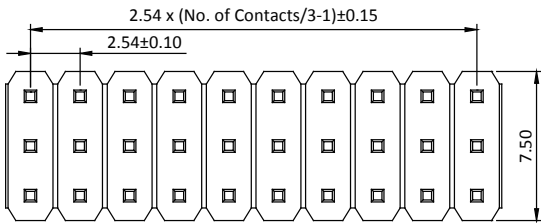
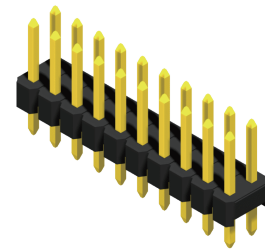

P/N.: 5PH1SDA15/17/25-3XX

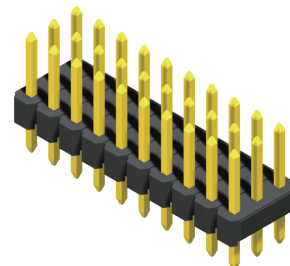

©: Standard Dimensions

Total length	Dim.A	Dim.B
11.60	6.00	3.00
13.90	8.10	3.30

P in Header 2.54mm



ROHS

ORDER INFORMATION

5	P	H	1	S	D	A	X	X	-	X	X	X	X	N	N	B	X	-	A/B	
										SD : Straight DIP	1: Single Row 2: Dual Row 3: Triple Row		No. of Contact H: 1.5mm/1.7mm Per Row (02~40) H: 2.5mm Per Row (02~50)		B: Bag		N: W/O Peg		U: RoHS Hi-Temp. L: RoHS + PBT	
										Plastic Height 15: H=1.5mm 17: H=1.7mm 25: H=2.5mm	©G0: Gold Flash GA: Gold 5u" GB: Gold 10u" GC: Gold 20u" GD: Gold 30u" T0: Tin Plated TE: Tin 200u"		S0: Selective SA: Selective 5u" SB: Selective 10u" SC: Selective 20u" SD: Selective 30u"		EX.: 060030000 A: 6.00(060) B: 3.00(030)					

©: Standard Recommend
 Tube package is not available for under 1*5 & 2*5 pin counts

Old P/N: PH1S15/17/25-1/2/3

AMTEK CONNECTORS MANUFACTURE