

**Appearance & Shape:** To be free from any defect such as flow, burrs, unevenness etc, As per IEC standards.

**Effective Parameters irrespective of material grade (per set)**

- Effective Length ( $L_e$ ): 120.0mm
- Effective Area ( $A_e$ ): 422.0mm<sup>2</sup>
- Effective Area ( $A_{Min}$ ): 419.0mm<sup>2</sup>
- Effective Volume ( $V_e$ ): 50640mm<sup>3</sup>

**Approximate weight : 253g/Set**



## EE5525 Un-gapped (OL)

**Test Conditions: 1kHz/1mT/CFR COIL,N=100/25°C**

Material Grade	Initial Permeability ( $\mu_{iac}$ )	AL Value (nH)	$P_v$ (W/set)	Ordering code
CF196	2000 $\pm$ 20%	7600 +30%/-20%	$\leq 6.98(200mT, 16kHz, 100^\circ C)$	CF196EE5525 OL
CF139	2100 $\pm$ 20%	7900 +30%/-20%	$\leq 5.06(100mT, 100kHz, 100^\circ C)$	CF139EE5525 OL
CF297	2300 $\pm$ 20%	8500 +30%/-20%	$\leq 4.56(100mT, 100kHz, 100^\circ C)$	CF297EE5525 OL

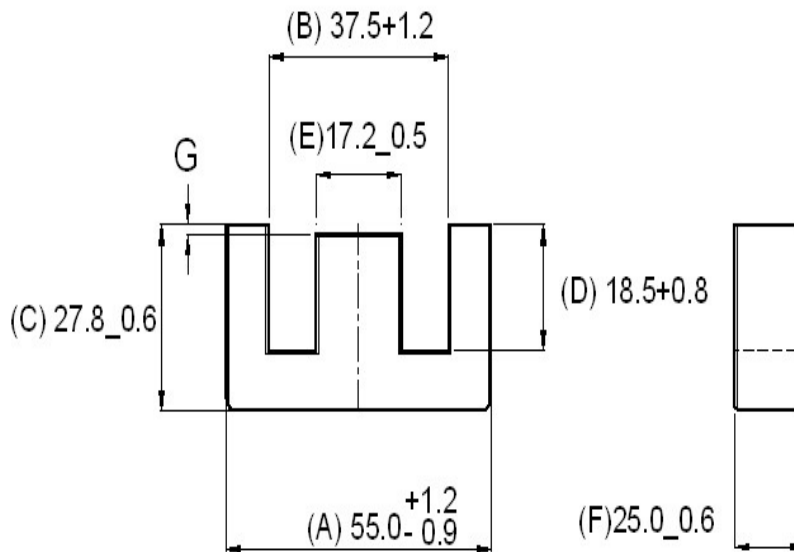

Remarks: Value of "G" is Zero (0) for Un-Gapped Cores, for Gapped Cores the value of "G" varies as per the Gap/AL value

For general terms and conditions please visit: [http://www.cosmoferrites.com/Downloads/Downloads/bcb70e7c-ae33-40ec-a881-0d5120db57b6\\_GTC.pdf](http://www.cosmoferrites.com/Downloads/Downloads/bcb70e7c-ae33-40ec-a881-0d5120db57b6_GTC.pdf)