

PRODUCT DATA APPROVAL SHEET

Core- ETD5922

Cosmo Ferrites Ltd. - INDIA

Appearance & Shape: To be free from any defect such as flow, burrs, unevenness etc, As per IEC standards.

Effective Parameters irrespective of material grade (per set)

- Effective Length (L_e): 139.0mm
- Effective Area (A_e): 368.0mm²
- Effective Area (A_{Min}): 368.0mm²
- Effective Volume (V_e): 51200mm³

Approximate weight (without Gap): 262g/Set

ETD5922 Un-gapped (OL)

Test Conditions: 1 KHz/300mV/N=100/25°C



Material	Initial Permeability (μ_{iac})	AL Value (nH)/Set	μ_e approx./Set	P_v (W/set)	Ordering code
CF196	2000 ±20%	5100 +30%/-20%	≈1523	≤7.0(200mT,16kHz,100°C)	CF196ETD5922 OL
CF139	2100 ±20%	5300 +30%/-20%	≈1618	≤5.1(100mT,100kHz,100°C)	CF139 ETD5922 OL
CF297	2300 ±20%	5500 +30%/-20%	≈1692	≤4.5(100mT,100kHz,100°C)	CF297ETD5922 OL

ETD5922 Gapp

Test Conditions: 1 KHz/300mV/N=100/25°C

Material	AL- Value(nH)/Set	S, T **)		D **)		Ordering Code
		Approx.Gap (mm)/Pc	μ_e approx./Set	Approx.Gap (mm)/Pc	μ_e approx./Set	
CF196	190 ±5%	≈3.0	≈45	≈1.50	≈45	CF196 ETD5922AL190 S/T/D**
CF139	190 ±5%	≈3.0	≈45	≈1.50	≈45	CF139 ETD5922AL190 S/T/D**
CF297	190 ±5%	≈3.0	≈45	≈1.50	≈45	CF297 ETD5922AL190 S/T/D**

***) S, T -> AL value in the table applies to a core set comprising one ungapped core (g=0) and one gapped core (g>0)

D -> AL value in the table applies to a core set comprising one gapped core (g>0) and one gapped core (g>0)

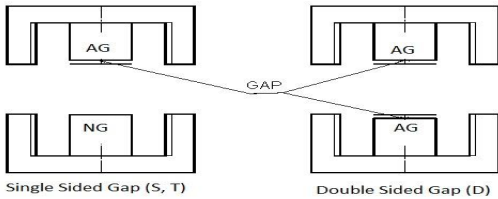

Delivery Procedure

S: 50% gapped Core and 50% Ungapped core

T: 100% gapped cores (ungapped core to be ordered separately)

D: 100% gapped cores

Dimensions :

Dimension	Nominal (in mm)	Maximum (in mm)	Minimum (in mm)
A	59.8	60.2	58.4
B	44.7	45.8	43.6
C	31.0	31.2	30.8
D	22.45	22.9	22.0
E	21.65	22.1	21.2
F	21.65	22.1	21.2

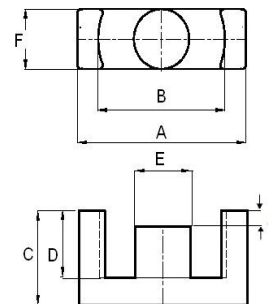

For Cosmo Ferrites Limited-INDIA

Checked By: A.K.

Approved By: B.S.

Authorized By: KSR

Date: 16-01-2013